

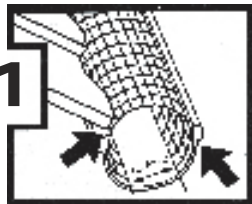

POLY-NET® LEAF-GUARD is easy to install, environmentally beneficial, UV resistant and weather proof.

simple principle, easy installation!



Press the plastic mesh tube gently together and place it inside the gutter. The slit has to face downward. The tube holds itself in place between the gutter and the roof overhang.

If the roof does not have an overhang, the tube should be additionally fixed in maximum intervals of 1 m.

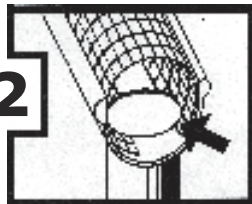

Cut out openings for downpipes. Remove the sieve in the downpipe.

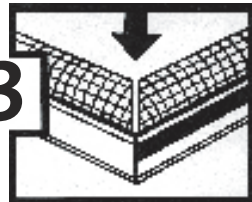

Make a mitered cut in corners.

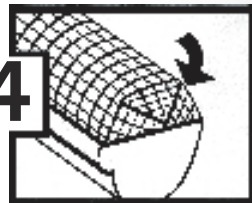

To prevent birds from nesting inside the tube, close off the ends by folding them under.

It always fits:

For gutter width	Type
80 mm	R 174/o
100 + 125 mm	R 172/o
150 + 180 mm	R 178/o

All data reflect the current state of NSW's technology and are intended solely to provide information on NSW products and their potential applications. They are not intended to guarantee product properties or the suitability of products for specific applications.

www.leaf-guard.com